

FOR LEASE



\$12.00/SF GROSS

457 Waterbury Court, Gahanna, OH 43230

Office Space for Lease - Suite D

- ±1,459 Sq Ft of lower level office space with 5 private offices
- Located near John Glen Airport with easy access to I-270
- Utilities, taxes, and common area maintenance INCLUDED
- Wide range of office businesses acceptable
- Select furniture is negotiable

Click Here For Video ▶

SANDRA AZEEZ

PHONE: 614-559-3350 EXT 121

EMAIL: SAZEEZ@BESTCORPORATEREALESTATE.COM

VALERIE TIVIN

PHONE: 614-559-3350 EXT 110

EMAIL: VTIVIN@BESTCORPORATEREALESTATE.COM



BEST CORPORATE REAL ESTATE

4608 SAWMILL ROAD, COLUMBUS, OH 43220 WWW.BESTCORPORATEREALESTATE.COM

This information has either been given to us by the Owner of the Property or received through sources that we deem to be reliable.

We have no reason to doubt its accuracy, but we do not guarantee it. *Line Drawings are Approximate*

Property Information

Property Address:	457 Waterbury Court
Parcel:	025-009309-00
County:	Franklin
Township:	Mifflin
Unit/Suite:	D
Availability:	Immediately
Building SQ FT:	±8,664
Unit Sq FT:	±1,459
Occupancy of Building:	83.2%
Year Built:	1990
Lease Rate:	\$12.00/ Sq Ft
Utilities:	Included
Restrooms:	Shared , Located in Common Area
Janitorial:	Common Areas Only
Parking:	Plenty
Signage:	Marque in Lobby

SANDRA AZEEZ
PHONE: 614-559-3350 EXT 121
EMAIL: SAZEEZ@BESTCORPORATEREALESTATE.COM

VALERIE TIVIN
PHONE: 614-559-3350 EXT 110
EMAIL: VTIVIN@BESTCORPORATEREALESTATE.COM



BEST CORPORATE REAL ESTATE
4608 SAWMILL ROAD, COLUMBUS, OH 43220 WWW.BESTCORPORATEREALESTATE.COM

This information has either been given to us by the Owner of the Property or received through sources that we deem to be reliable.
We have no reason to doubt its accuracy, but we do not guarantee it. *Line Drawings are Approximate*

457 Waterbury Court, Gahanna, OH 43230



Shared Entry



Private Entry

SANDRA AZEEZ

PHONE: 614-559-3350 EXT 121

EMAIL: SAZEEZ@BESTCORPORATEREALESTATE.COM

VALERIE TIVIN

PHONE: 614-559-3350 EXT 110

EMAIL: VTIVIN@BESTCORPORATEREALESTATE.COM



BEST CORPORATE REAL ESTATE

4608 SAWMILL ROAD, COLUMBUS, OH 43220 WWW.BESTCORPORATEREALESTATE.COM

This information has either been given to us by the Owner of the Property or received through sources that we deem to be reliable.

We have no reason to doubt its accuracy, but we do not guarantee it. *Line Drawings are Approximate*

457 Waterbury Court, Gahanna, OH 43230

Common Spaces



SANDRA AZEEZ
PHONE: 614-559-3350 EXT 121
EMAIL: SAZEEZ@BESTCORPORATEREALESTATE.COM

VALERIE TIVIN
PHONE: 614-559-3350 EXT 110
EMAIL: VTIVIN@BESTCORPORATEREALESTATE.COM



BEST CORPORATE REAL ESTATE
4608 SAWMILL ROAD, COLUMBUS, OH 43220 WWW.BESTCORPORATEREALESTATE.COM

This information has either been given to us by the Owner of the Property or received through sources that we deem to be reliable.
We have no reason to doubt its accuracy, but we do not guarantee it. *Line Drawings are Approximate*

457 Waterbury Court, Gahanna, OH 43230

Unit D



SANDRA AZEEZ

PHONE: 614-559-3350 EXT 121

EMAIL: SAZEEZ@BESTCORPORATEREALESTATE.COM

VALERIE TIVIN

PHONE: 614-559-3350 EXT 110

EMAIL: VTIVIN@BESTCORPORATEREALESTATE.COM



BEST CORPORATE REAL ESTATE
4608 SAWMILL ROAD, COLUMBUS, OH 43220 WWW.BESTCORPORATEREALESTATE.COM

This information has either been given to us by the Owner of the Property or received through sources that we deem to be reliable.
We have no reason to doubt its accuracy, but we do not guarantee it. *Line Drawings are Approximate*

457 Waterbury Court, Gahanna, OH 43230

Unit D



SANDRA AZEEZ

PHONE: 614-559-3350 EXT 121

EMAIL: SAZEEZ@BESTCORPORATEREALESTATE.COM

VALERIE TIVIN

PHONE: 614-559-3350 EXT 110

EMAIL: VTIVIN@BESTCORPORATEREALESTATE.COM



BEST CORPORATE REAL ESTATE
4608 SAWMILL ROAD, COLUMBUS, OH 43220 WWW.BESTCORPORATEREALESTATE.COM

This information has either been given to us by the Owner of the Property or received through sources that we deem to be reliable.
We have no reason to doubt its accuracy, but we do not guarantee it. *Line Drawings are Approximate*

457 Waterbury Court, Gahanna, OH 43230

Parcel View

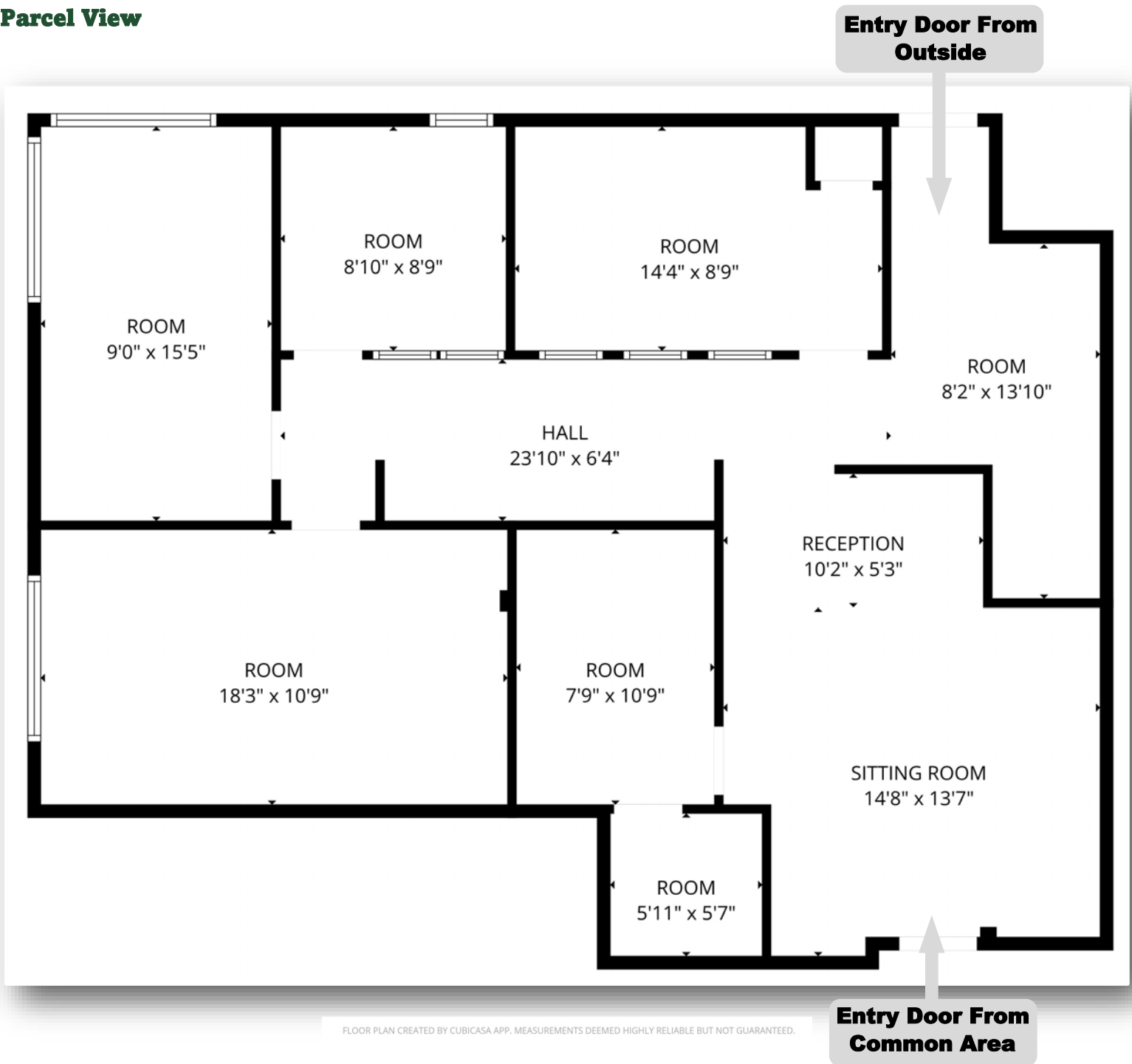

SANDRA AZEEZ

PHONE: 614-559-3350 EXT 121

EMAIL: SAZEEZ@BESTCORPORATEREALESTATE.COM

VALERIE TIVIN

PHONE: 614-559-3350 EXT 110

EMAIL: VTIVIN@BESTCORPORATEREALESTATE.COM



BEST CORPORATE REAL ESTATE

4608 SAWMILL ROAD, COLUMBUS, OH 43220 WWW.BESTCORPORATEREALESTATE.COM

This information has either been given to us by the Owner of the Property or received through sources that we deem to be reliable.

We have no reason to doubt its accuracy, but we do not guarantee it. *Line Drawings are Approximate*

457 Waterbury Court, Gahanna, OH 43230

Parcel View



SANDRA AZEEZ
PHONE: 614-559-3350 EXT 121
EMAIL: SAZEEZ@BESTCORPORATEREALESTATE.COM

VALERIE TIVIN
PHONE: 614-559-3350 EXT 110
EMAIL: VTIVIN@BESTCORPORATEREALESTATE.COM



BEST CORPORATE REAL ESTATE
4608 SAWMILL ROAD, COLUMBUS, OH 43220 WWW.BESTCORPORATEREALESTATE.COM

This information has either been given to us by the Owner of the Property or received through sources that we deem to be reliable.
We have no reason to doubt its accuracy, but we do not guarantee it. *Line Drawings are Approximate*

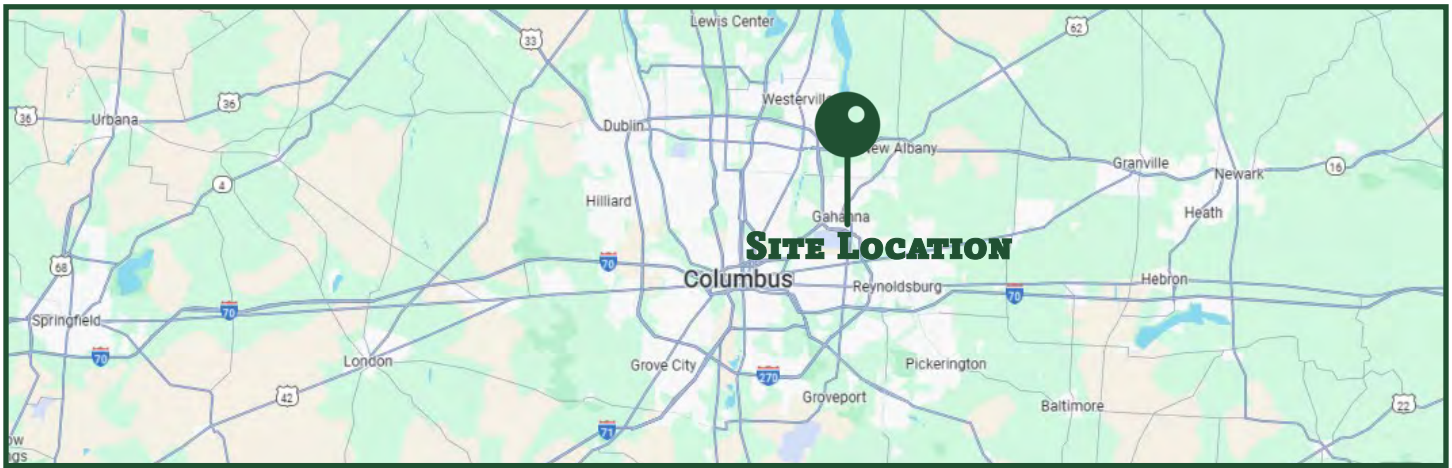

TRAFFIC OVERVIEW (2025)

Street	Avg Daily Volume
Hamilton Road - Morrison Rd	32,976
S Hamilton Rd - I-270	25,089
Morrison Road - Offcenter Pl	16,265

Nearby Major Roads and Highways:



DEMOGRAPHICS

		WITHIN 1 MILE	WITHIN 3 MILES	WITHIN 5 MILES
Population (2024)		3,672	29,497	123,638
Households (2023)		3,967	20,261	66,154
Avg Household Income (2024)		\$71,070	\$71,002	\$65,296

SANDRA AZEEZ
 PHONE: 614-559-3350 EXT 121
 EMAIL: SAZEEZ@BESTCORPORATEREALESTATE.COM

VALERIE TIVIN
 PHONE: 614-559-3350 EXT 110
 EMAIL: VTIVIN@BESTCORPORATEREALESTATE.COM



BEST CORPORATE REAL ESTATE
 4608 SAWMILL ROAD, COLUMBUS, OH 43220 WWW.BESTCORPORATEREALESTATE.COM

This information has either been given to us by the Owner of the Property or received through sources that we deem to be reliable.
 We have no reason to doubt its accuracy, but we do not guarantee it. *Line Drawings are Approximate*

Regional Overview

Gahanna, recognized as one of Ohio Magazine's 'Best Hometowns,' boasts over 750 acres of parkland, vibrant neighborhoods, and ample opportunities for business growth. Its rich heritage and diverse community create a welcoming atmosphere with unique historic sites, excellent dining options, eclectic shops, and expansive green spaces. Just eight miles from downtown Columbus and a short drive from John Glenn International Airport, Gahanna is ideally situated for both business and leisure travelers. Emphasizing community, family, and enjoyment, Gahanna hosts numerous seasonal and special events throughout the year. Explore Creekside Park, featuring picturesque waterfalls, paddleboat rides, and a variety of dining options. Discover the Ohio Herb Center, tour local wineries, and attend exciting premier events.



35,715

Residents (2024)



14,353

Households (2024)



\$89,945

Median Income (2024)



7.33%

Growth Rate to
Year Prior (2024)



50 (774 AC)

Parks



\$256,868

Median Home Value
(2024)

Top Investors and Employers

GAP

intel

**AMERICAN
ELECTRIC
POWER**

Huntington

Whirlpool
CORPORATION

DSW
DESIGNER SHOE WAREHOUSE™

VERTIV

HYPERION
Materials & Technologies

amazon

Walmart

TARGET

Lbrands

THE INFORMATION/IMAGES WERE GATHERED FROM www.gahanna.gov and Visit Gahanna

This information has either been given to us by the Owner of the Property or received through sources that we deem to be reliable. We have no reason to doubt its accuracy, but we do not guarantee it.

NOTABLE PROJECTS COMING TO COLUMBUS (2025)

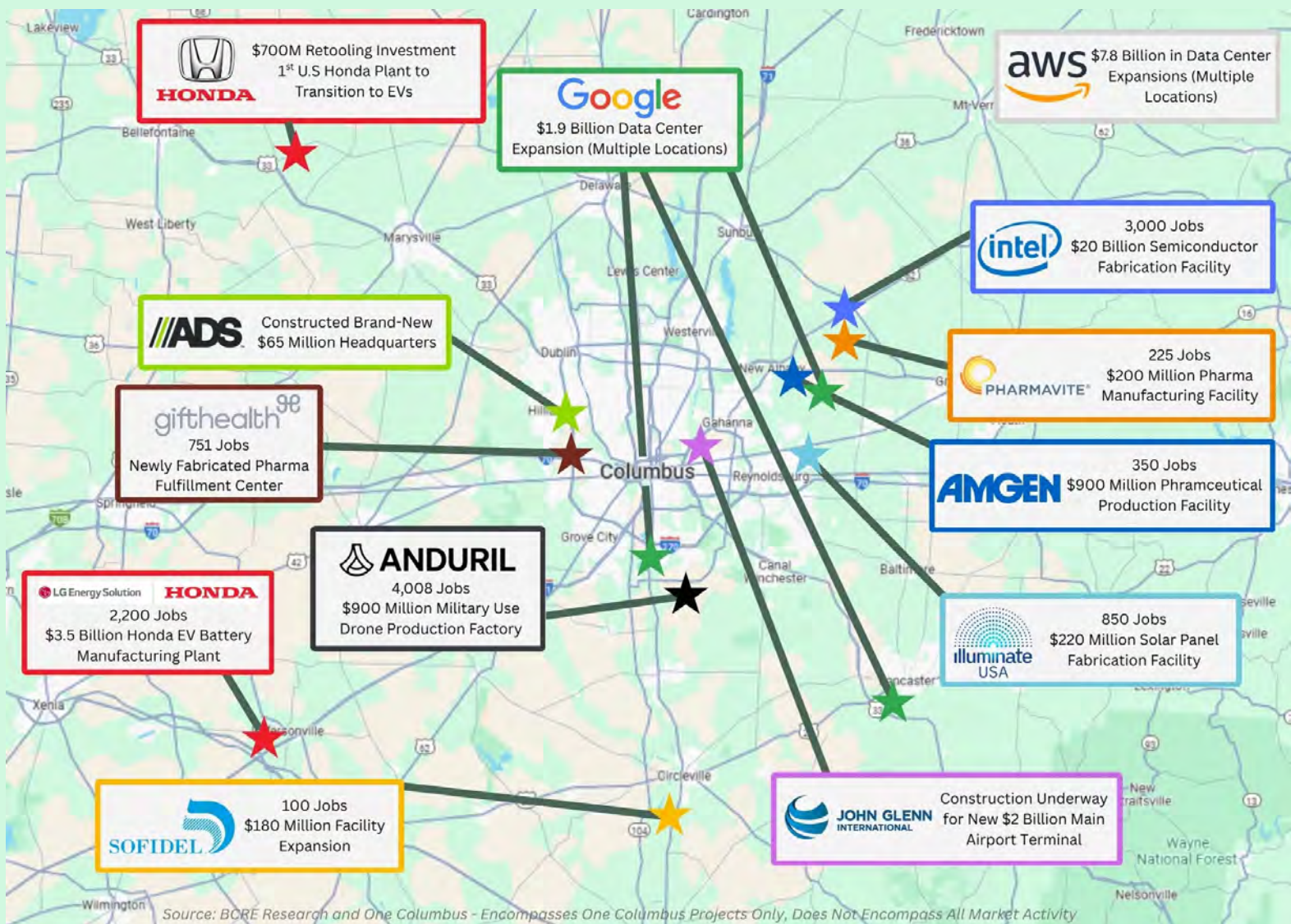

**129 NEW PROJECTS ANNOUNCED
IN 3 YEARS**

**\$1.7 BILLION IN NEWLY
GENERATED PAYROLL**

**18,200+ NEW JOBS COMING TO
THE AREA**

**\$34 BILLION IN NEW CAPITAL
INVESTMENTS**

SANDRA AZEEZ
PHONE: 614-559-3350 EXT 121
EMAIL: SAZEEZ@BESTCORPORATEREALESTATE.COM

VALERIE TIVIN
PHONE: 614-559-3350 EXT 110
EMAIL: VTIVIN@BESTCORPORATEREALESTATE.COM



BEST CORPORATE REAL ESTATE
4608 SAWMILL ROAD, COLUMBUS, OH 43220 WWW.BESTCORPORATEREALESTATE.COM

This information has either been given to us by the Owner of the Property or received through sources that we deem to be reliable.
We have no reason to doubt its accuracy, but we do not guarantee it. *Line Drawings are Approximate*

Disclaimer And Confidentiality Agreement

Best Corporate Real Estate has been retained as the broker regarding the sale/lease of this property/business.

This information is intended solely for the LIMITED use by the parties to consider whether to pursue an intent to offer or lease this property/business.

Although the information contained herein is believed to be correct, Best Corporate Real Estate, the Owner, and their officer's, agents and/or employees disclaim, any and all liability for representations, warranties, and or guarantees, expressed and/or implied, contained herein, or any omissions from the information being provided. This includes any additional oral or written communication made available to the recipient.

This information contains a brief overview of selected information pertaining to the affairs of the property/business. It does not claim to contain all the information a prospect may desire or require. There is no representation, warranty, expressed or implied as to the accuracy or completeness of the information, and there will be no liability of any kind whatsoever assumed by the Broker or Owner with respect hereto. Analysis and verification of this information is solely the responsibility of the prospect.

By accepting the receipt of this information, this confidentiality information is to be kept by the interested parties only. By accepting these documents, you are stating that you might be interested in pursuing an offer for the property/business. The enclosed contains information, pictures, and other materials that are informational only. Best Corporate Real Estate and the Owner does not deem this information to be all inclusive nor contain everything that a purchaser may require. The purchaser is responsible for reviewing for accuracy and the details of this information and may request additional information if desired.

By accepting this information, the potential prospect and/or the prospect's broker agree that the property information is confidential. Duplication or photocopying (all or in part) is not permitted. Best Corporate Real Estate deems this information reliable but cannot be made accountable for its accuracy. The owner of the property/business reserves the right to make any change, to add, delete, or modify the information at any time. The Owner reserves the right to reject any potential offer at any time without notice. This property information is not to be construed as an offer, a contract, or commitment.

The potential purchaser and or purchaser's broker is not allowed to communicate, interview, or represent to tenant/employee's that the property/business is for sale/lease.

No representation is made by Best Corporate Real Estate or Owner as to the accuracy or completeness of the information or photographs contained herein, and nothing contained herein is, or shall be relied on as, a promise or representation as to the future performance of the property/business.

Prospective Purchaser may not interview the tenants, represent to the tenants that the Property is for sale, or represent to the tenants that the Prospective Purchase is buying the property without written consent from the Owner.

Disclaimer And Confidentiality Agreement - Continued -

Additional Information and an opportunity to inspect the Property will be made upon written request by interested and qualified prospective investors and upon execution of a Confidentiality Agreement.

By the accepting this information, you agree that you will hold and treat it in the strictest confidence, that you will not photocopy or duplicate it, that you will not disclose this information or any of the contents to any other entity without the prior written authorization.

By acknowledgement of receipt of the Property information, Prospect and Broker agree that the Property information is confidential, proprietary and the exclusive possession of Owner and further that you will hold and treat it in the strictest of confidence, that you will not directly or indirectly disclose, or permit anyone else to disclose, the Property information to any other person, firm or entity, without prior written authorization.

Prospect and/or Broker further agree that they will not duplicate, photocopy or otherwise reproduce the Property information in whole or in part or otherwise use or permit it to be used in any fashion.

Prospect and Broker hereby agree to indemnify Owner and Owner's Broker from any loss or damage, which may be suffered as a result of the breach of the terms and conditions of this Confidentiality Agreement. Owner expressly reserves the right at Owner's sole, singular, exclusive and arbitrary discretion to reject any or all proposals or expressions of interest in this Property and can terminate discussions in connection with any party at any time without notice or cause.

This information shall not be deemed to represent the state of affairs of the Property/Business or constitute an indication that there has been no change in the business or affairs of the Property since the date of preparation of this information.

The information provided has been gathered from sources that are deemed reliable, but the Owner does not warrant or represent or guarantee that the information is true or accurate. Again, you are advised to verify all information independently.

The inclusion or exclusion of information relating to any hazardous, toxic or dangerous chemical item, waste or substance relating to the property/business shall in no way be construed as creating any warranties or representations, expressed or implied by the Owner or its Broker/Agents as to the existence or nonexistence or any potential hazardous material.

